

## S5000 TECHNICAL BULLETIN

Date	18/10/2022
Topic	Push Rod & Steering Adjusters
Priority	Mandatory

### PROBLEM:

Failures of the front, rear and steering adjusters have been occurring when the vehicle is subjected to large jolts, typically seen when the driver dips a wheel off the edge of the circuit.



The current failure mode with the significant bending of the adjusters is not ideal as a large variation in push rod and steering arm length occurs as a result.

This is not ideal as the vehicle typically becomes uncontrollable due to large variations in corner weight.

### SOLUTION:

The material specifications have been altered to increase the load capacity of the adjuster's, latest specification adjusters now have the following part numbers and are mandatory:

Steering Arm Adjuster – GRM-AF0452-02

Front Push Rod Adjuster – GRM-AF0451-03

Rear Push Rod Adjuster – GRM-AG0475-03

Latest specification adjusters can be identified by the presence of 2 notches grooved into the hex as seen below:

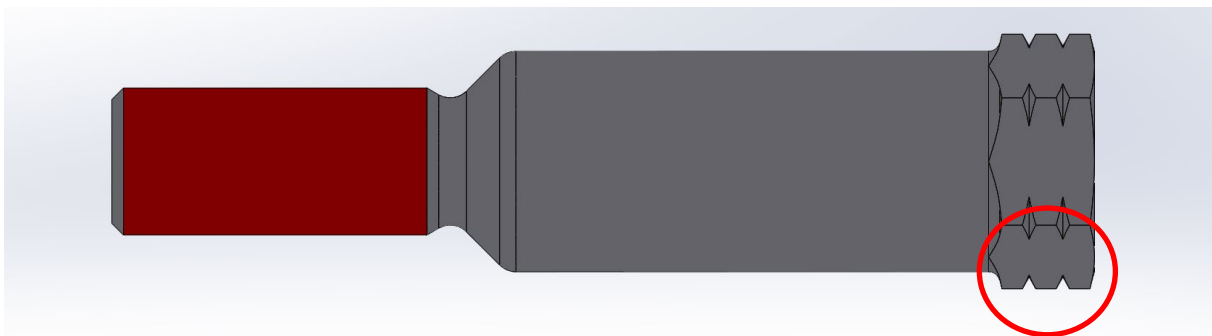

These adjusters are currently being manufactured and will be distributed to teams ASAP.

Any questions please contact [s5000@grmotorsport.com.au](mailto:s5000@grmotorsport.com.au)