

RECOGNITION DOCUMENT

**1 GENERAL**

**1.1 MANUFACTURER**

**Garry Rogers Motorsport**

**1.2 MODEL**

**S5000**

Full Car from 3/4 Front



Full Car from 3/4 Rear



Chassis ID Plate 1 – Located LHS of Steering Wheel



Chassis ID Plate 2- Located RHS of Steering Wheel



## 2 DIMENSIONS

### 2.1 WHEELBASE

**3090** mm +/- **5** mm

### 2.2 TRACK (MEASURED TO THE WIDEST POINT OF THE TYRE)

Front	<b>2020</b>	mm	Max
Rear	<b>2020</b>	mm	Max

### 2.3 BALLAST POSITIONS

Position 1	<b>Inside cockpit, underneath driver's knee</b>	Attachment	<b>2x M8x1.25</b>
Position 2	<b>Inside cockpit, forward of pedal box</b>	Attachment	<b>2x M8x1.25</b>

Photo of Ballast Position 1

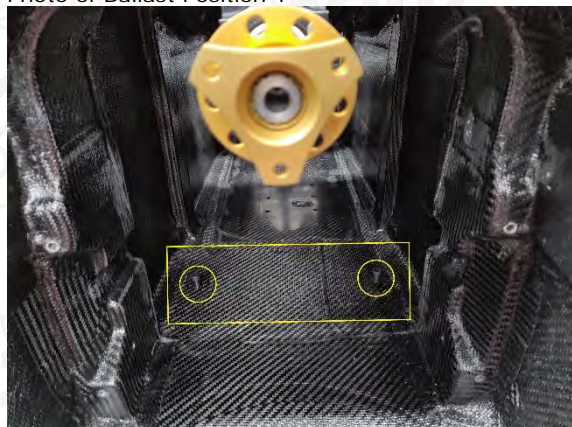
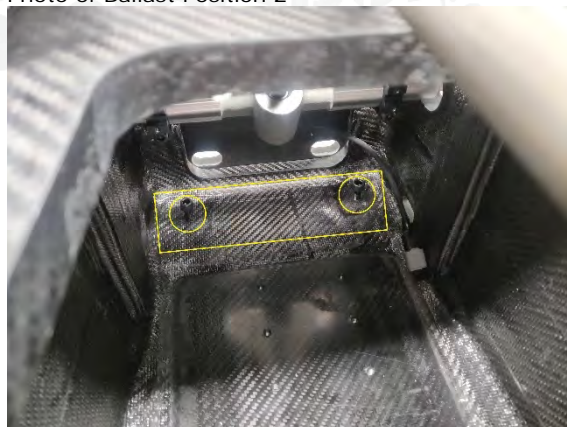

Photo of Ballast Position 2



### 2.4 TIMING TRANSPONDER POSITION

Photo of Timing Transponder Position



Dimension of Timing Transponder Position

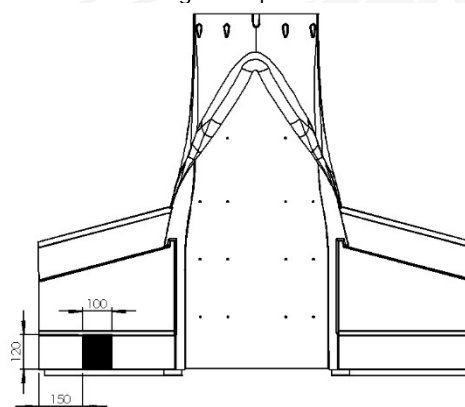



### 3 SAFETY STRUCTURES

#### 3.1 CHASSIS (TYPE 1)

Manufacturer  
Part Number

**Liger**  
**JS F3 S5000**

#### 3.2 SAFETY BELTS (TYPE 3)

Manufacturer  
FIA Homologation

**Sabelt**  
**FIA8853-2016**

#### 3.3 EXTRACTION SEAT (TYPE 1)

Photo of Extraction Seat Unmounted



#### 3.4 MAIN HOOP & HALO (TYPE 1)

Photo of Main Hoop Mounted



Photo of Halo Mounted



### 3.5 FIRE EXTINGUISHER (TYPE 3)

Manufacturer  
Homologation  
Model  
P/N

**Lifeline**  
**EX.042.17**  
**Zero 360 2.25KG Electric**  
**106-001-005**

Photo of Fire Extinguisher Mounted



Photo of Fire Extinguisher Unmounted



Photo of Engine Nozzles (both sides)



Photo of Cockpit Nozzle





### 3.6 WHEEL TETHERS FRONT (TYPE 1)

Manufacturer **Future Fibres**  
Type **FF-6KJ-103**  
FIA Homologation **8864-2013**  
Length (fore) **780**  
Length (aft) **845**

mm  
mm

Photo of Front Wheel Tethers Mounted



Photos of Front Wheel Tethers Unmounted



Photo of Wheel Tether Fixation Vehicle Side



Photo of Wheel Tether Fixation Upright Side



### 3.7 WHEEL TETHERS REAR (TYPE 1)

Manufacturer **Future Fibres**  
Type **FF-6KJ-103**  
FIA Homologation **8864-2013**  
Length (fore & aft) **685**

mm

Photo Rear Wheel Tethers Mounted



Photos of Rear Wheel Tethers Unmounted



Photo of Wheel Tether Fixation Vehicle Side (aft)



Photo of Wheel Tether Fixation Vehicle Side (fore)



Photo of Wheel Tether Fixation Upright Side

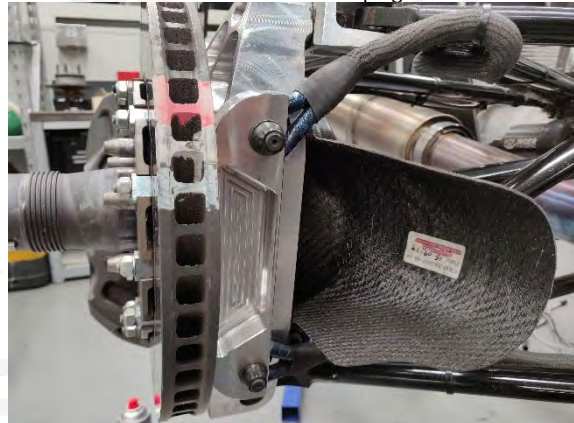



### 3.8 RAIN LIGHT (TYPE 3)

Manufacturer

**Lifeline**

Part Number

**421-100-005**

Photo of Rain Light Mounted



Photo Rain Light Unmounted



## 4 BODYWORK

### 4.1 FRONT CRASH STRUCTURE (TYPE 1)

Photo of Front Crash Structure Mounted



Dimensions of Front Crash Structure

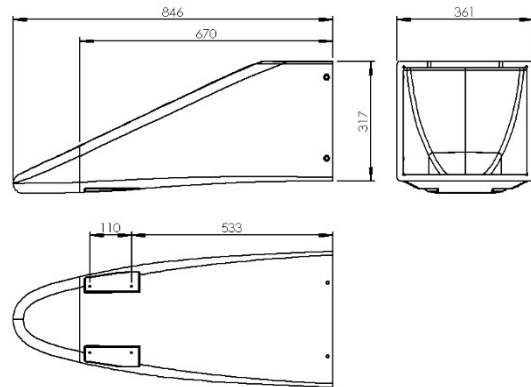

Photo of Front Crash Structure Unmounted

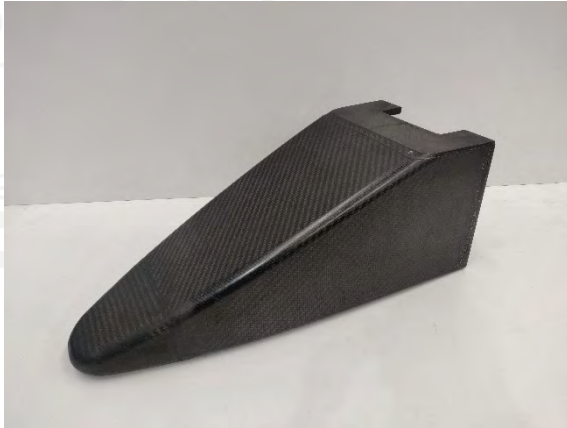
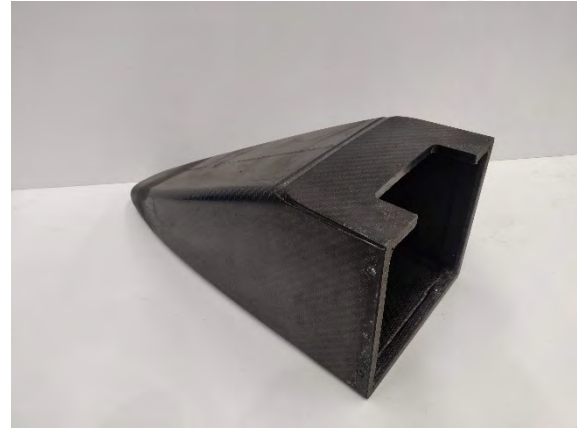

Photo Front Crash Structure Unmounted



### 4.2 FRONT WING MAIN ELEMENT (TYPE 1)

Photo of Front Wing Main Element Mounted



Dimensions of Front Wing Main Element

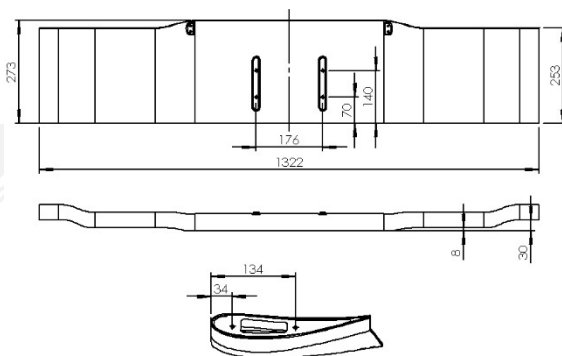



Photo of Front Wing Main Element 3/4 Unmounted



Photo of Front Wing Main Element 3/4 Unmounted



#### 4.3 FRONT WING SECONDARY ELEMENTS (TYPE 1)

Photo of Front Wing Secondary Element Mounted



Dimensions of Front Wing Secondary Element

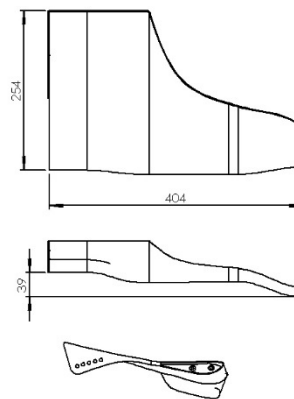

Photo of Front Wing Secondary Element 3/4 Unmounted with Bracket

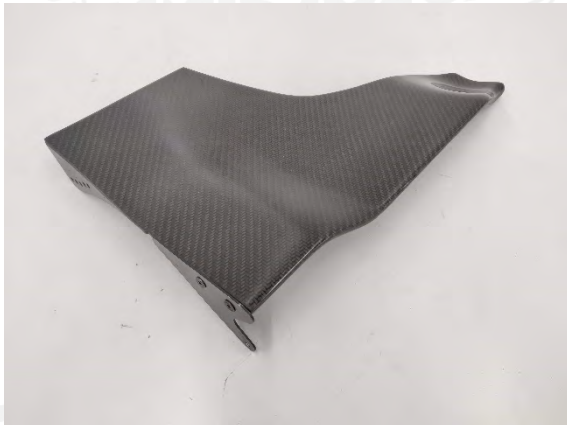
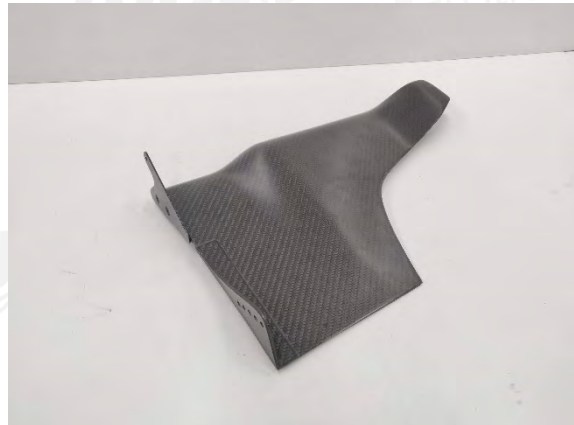
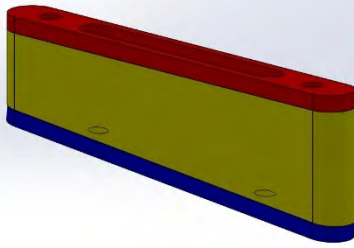

Photo of Front Wing Secondary Element 3/4 Unmounted with Bracket



#### 4.4 FRONT WING MOUNTING (TYPE 1)

Photo of Front Wing Mounting Unmounted



Dimensions of Front Wing Mounting

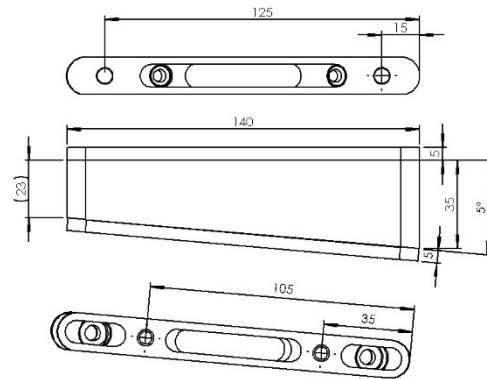
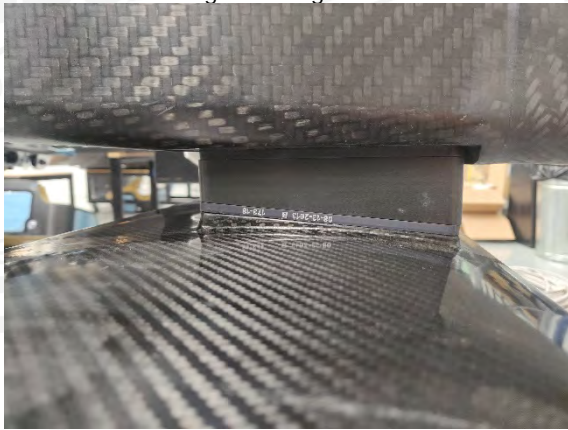

Photo of Front Wing Mounting Mounted



#### 4.5 FRONT WING ENDPLATE (TYPE 1)

Photo of Front Wing Endplate Unmounted



Dimensions of Front Wing Endplate

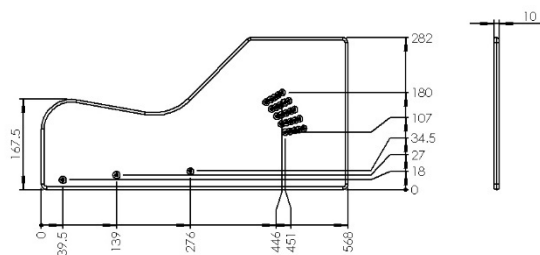



#### 4.6 REAR CRASH STRUCTURE (TYPE 1)

Photo of Rear Crash Structure Mounted



Dimensions of Rear Crash Structure

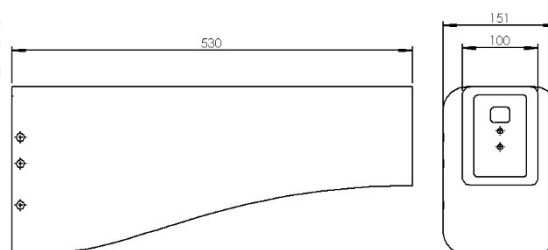

Photo of Rear Crash Structure Unmounted



Photo of Rear Crash Structure Unmounted



#### 4.7 REAR WING (TYPE 1)

Photo of Rear Wing Mounted



Dimensions of Rear Wing

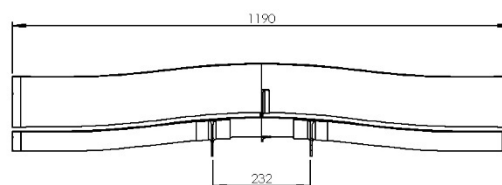

Photo of Rear Wing Unmounted



Photo of Rear Wing Unmounted



#### 4.8 REAR WING MOUNTING (TYPE 1)

Photo of Rear Wing Mount Unmounted



Dimensions of Rear Wing Mount

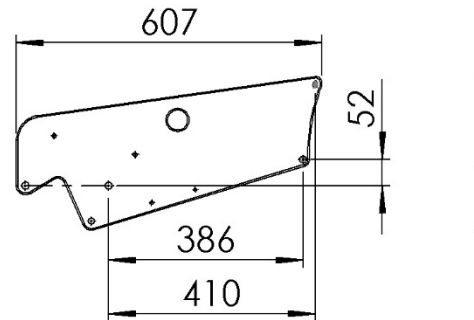

#### 4.9 REAR WING ENDPLATE (TYPE 1)

Photo of Rear Wing Endplate Unmounted

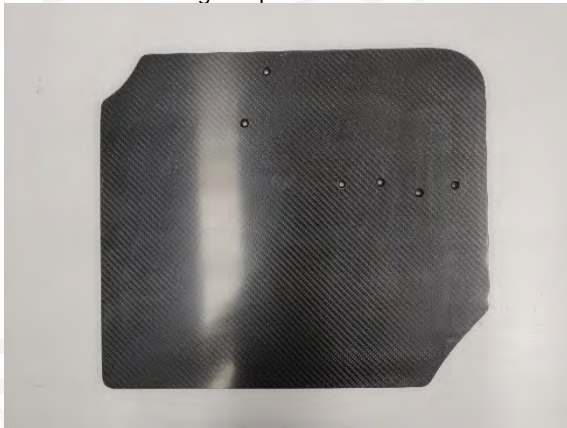

Dimensions of Rear Wing Endplate

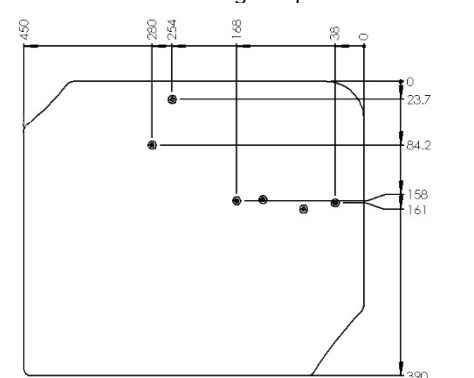



#### 4.10 UPPER BODYWORK (TYPE 2)

Permitted Freedoms:

- **Local modification to damper cover to allow fitment of radio antenna**

Photo of Upper Bodywork Unmounted



Photo of Upper Bodywork Unmounted



Photo of Damper Cover Unmounted



Photo of Engine Cover Unmounted

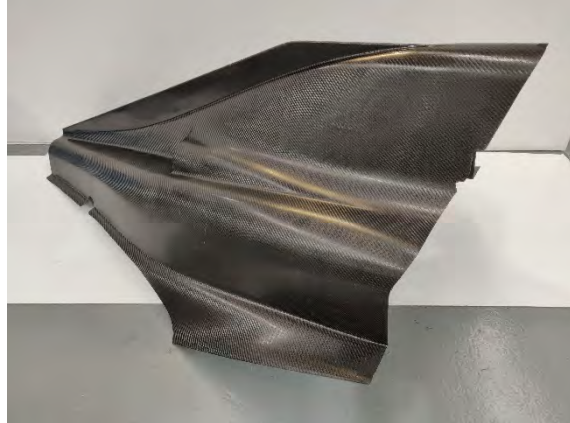

Photo of RHS Sidepod Unmounted

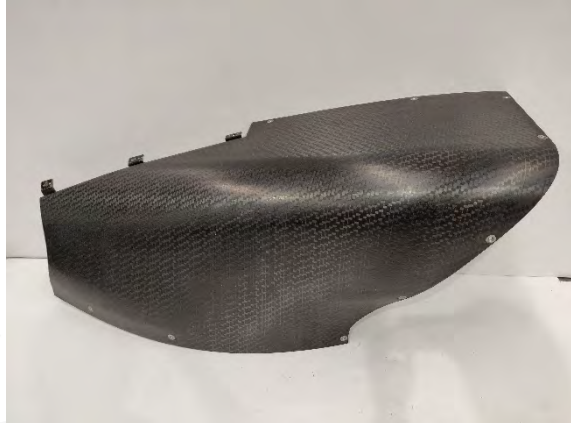

Photo of RHS Sidepod Unmounted





Photo of LHS Sidepod Unmounted

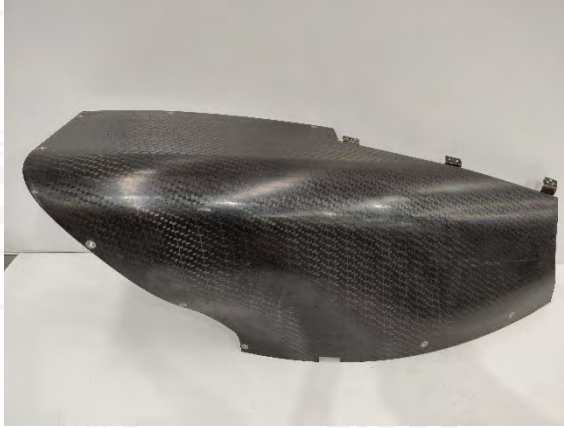

Photo of LHS Sidepod Unmounted



Photo of RHS Front Sidepod Bodywork Mounted

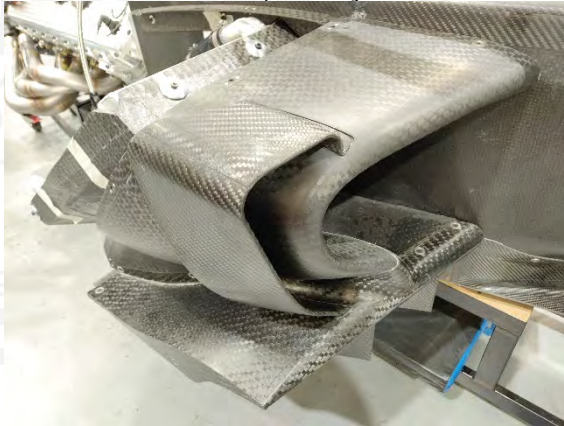

Photo of LHS Front Sidepod Bodywork Mounted



#### 4.11 LOWER BODYWORK (TYPE 1)

Photo of Lower Bodywork Mounted



Photo of Lower Bodywork Mounted





Photo of Lower Bodywork Unmounted



Photo of Lower Bodywork Unmounted



Photo of LHS Lower Bodywork Fins Mounted

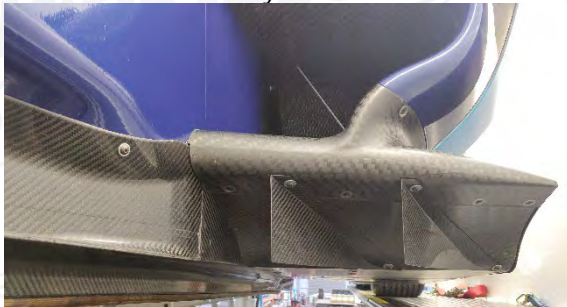
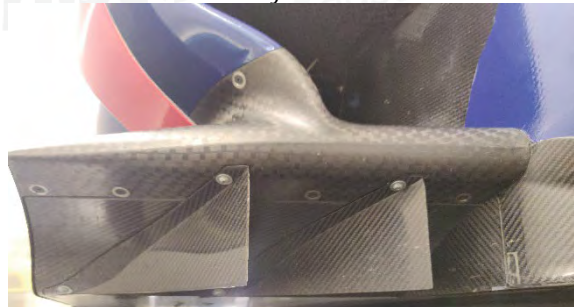
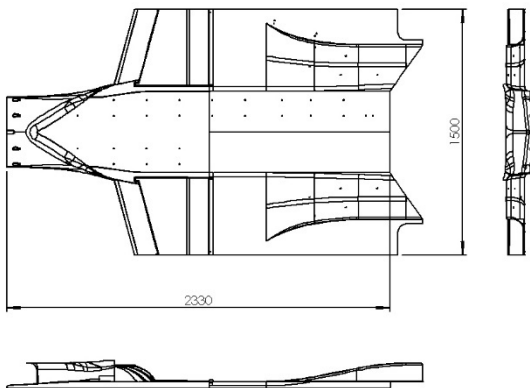

Photo of RHS Lower Bodywork Fins Mounted



Dimensions of Lower Bodywork



#### 4.12 WOODEN FLOOR (TYPE 1)

Photo of Wooden Floor Unmounted

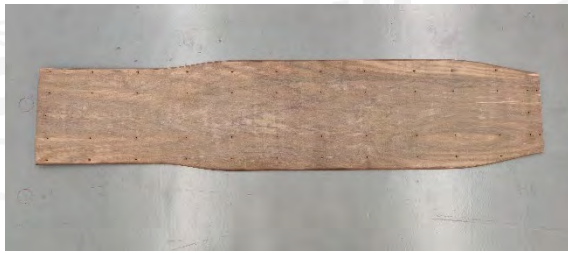

Dimensions of Wooden Floor

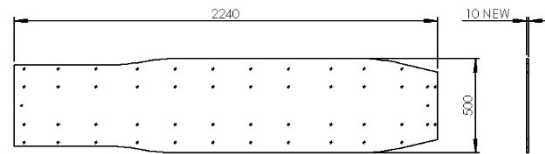

#### 4.13 SKID BLOCK (TYPE 1)

Minimum Thickness **2**

mm

**Minimum thickness will be measured only around the four 80 mm diameter holes; the minimum thickness must be respected in at least one place on the circumference of all four holes.**

Photo of Skid Block Unmounted



Dimensions of Skid Block

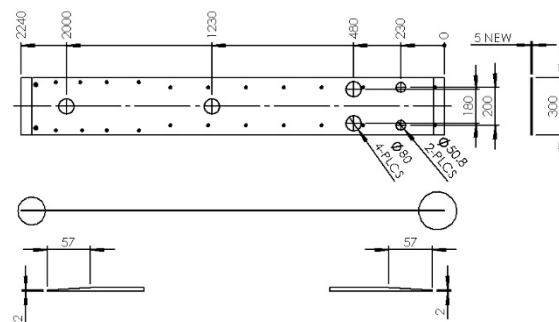

#### 4.14 SPARK BLOCK (TYPE 1)

Photo of Spark Blocks Mounted



Dimensions of Spark Block

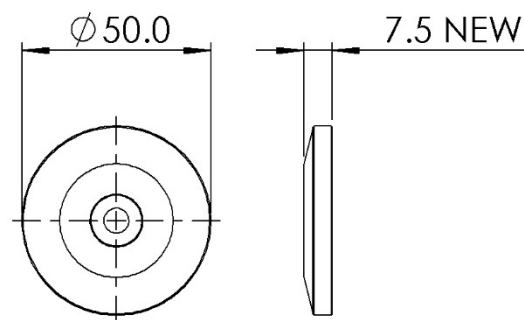



#### 4.15 MIRRORS (TYPE 2)

Permitted Freedoms:

- **Can be mounted with or without extension spacer**

Photo of Mirror Mounted



#### 4.16 WINDSCREEN (TYPE 1)

Photo of Windscreen Mounted



Photo of Windscreen Mounted



#### 4.17 FLOOR STAYS (TYPE 1)

Photo of Floor Stays Mounted



## 5 SUSPENSION

### 5.1 FRONT UPRIGHT (TYPE 1)

Photo of Bare Front Upright Unmounted



Dimensions of Bare Front Upright

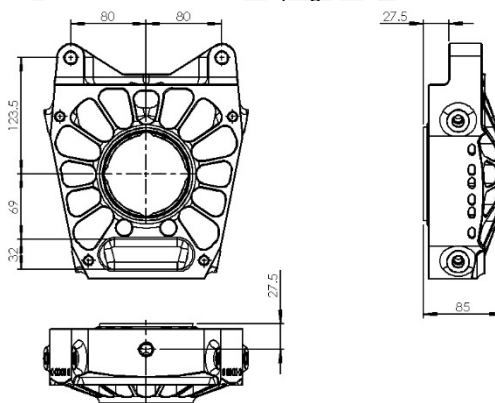

Photo of Front Upright Assembly Unmounted



Photo of Front Upright Assembly Unmounted



Photo of aluminium tape to protect water ingress

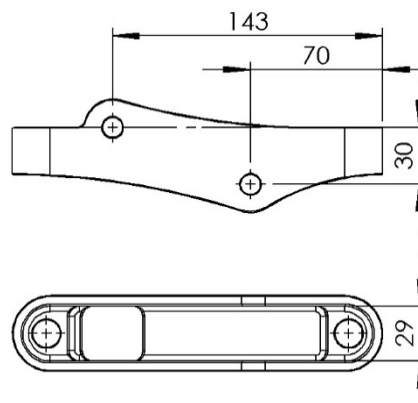



Photo of Front Camber Plate Unmounted



Dimensions of Front Camber Plate



## 5.2 REAR UPRIGHT (TYPE 1)

Photo of Bare Rear upright Unmounted



Dimensions of Bare Rear Upright

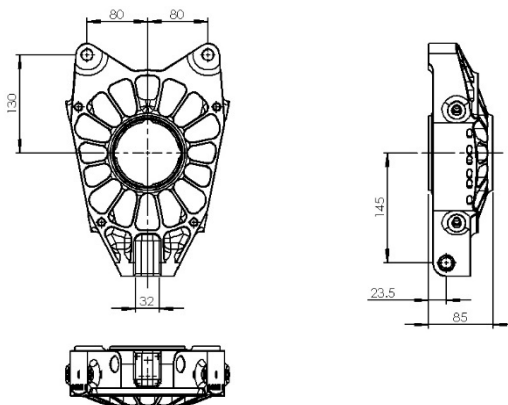

Photo of Rear Upright Assembly Unmounted



Photo of Rear Upright Assembly Unmounted



Photo of aluminium tape to protect water ingress



Photo of Rear Camber Plate Unmounted



Dimensions of Rear Camber Plate

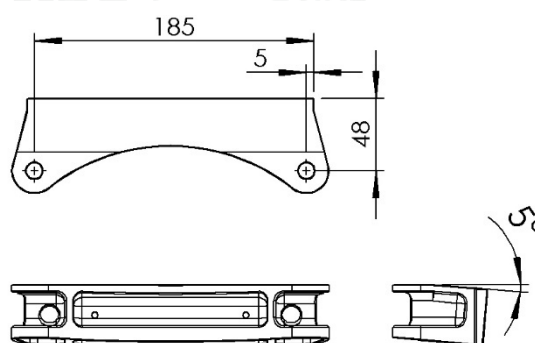

### 5.3 FRONT SUSPENSION

Photo of RHS Front Suspension Mounted



Photo of LHS Front Suspension Mounted

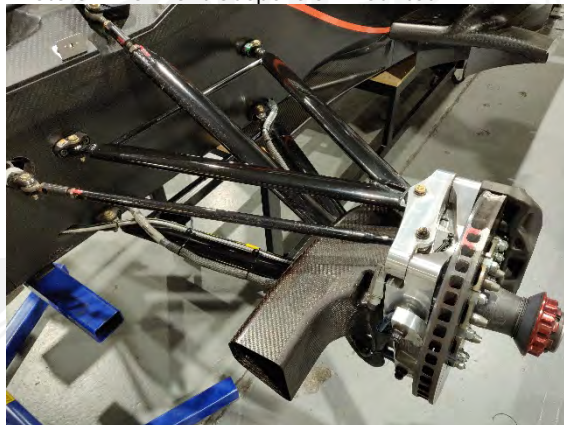



#### 5.4 FRONT UPPER WISHBONE (TYPE 2)

Permitted Freedoms:

- **Spherical bearings may be replaced**

Photo of Front Upper Wishbone Unmounted with Clevis and Spacers



Dimensions of Front Upper Wishbone

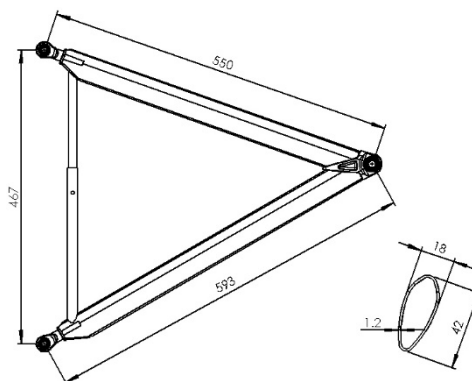

Photo of Front Upper Wishbone Clevis (fore and aft) Unmounted



Dimensions of Front Upper Wishbone Clevis

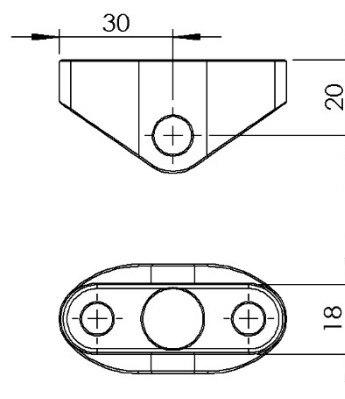
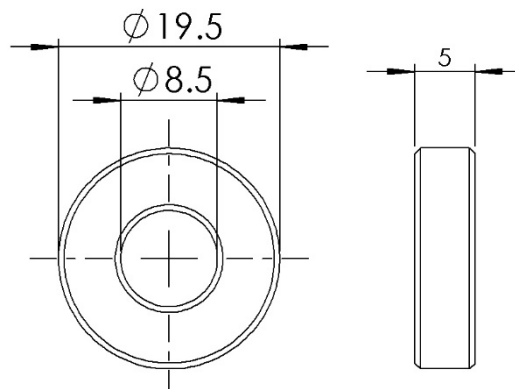

Photo of Front Upper Wishbone Clevis Spacer Unmounted



Dimensions of Front Upper Wishbone Clevis Spacer



## 5.5 FRONT LOWER WISHBONE (TYPE 2)

Permitted Freedoms:

- **Spherical bearings and rod ends may be replaced**

Photo of Front Lower Wishbone Unmounted with Clevis



Dimensions of Front Lower Wishbone

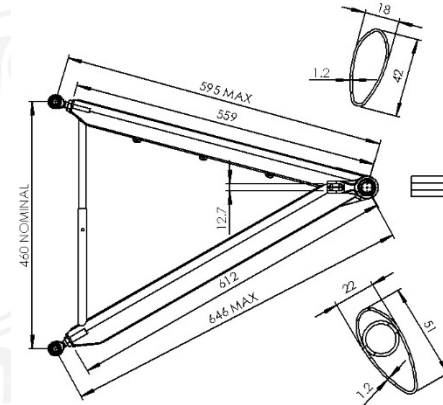
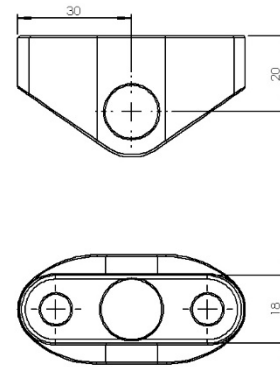

Photo of Front Lower Wishbone Clevis (fore and aft) Unmounted



Dimensions of Front Lower Wishbone Clevis





## 5.6 FRONT PUSHROD (TYPE 2)

Permitted Freedoms:

- **Spherical bearings and rod ends may be replaced**

Photo of Front Pushrod Unmounted



Dimensions of Front Pushrod

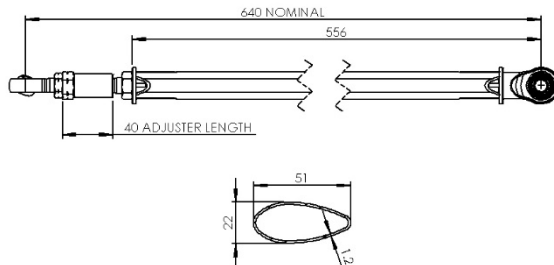

## 5.7 FRONT ANTI ROLL BAR (TYPE 2)

Diameter **12** mm

Permitted Freedoms:

- **Spherical bearings and rod ends may be replaced**
- **1 ARB link may be disconnected or removed**

Photo of Front Anti Roll Bar Mounted



Photo of Front Anti Roll Bar Unmounted



Dimensions of Front Anti Roll Bar

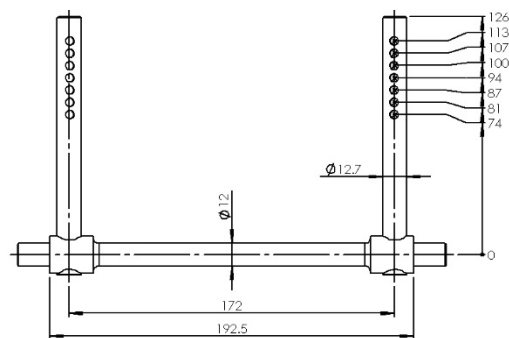

## 5.8 FRONT DAMPER (TYPE 2)

Manufacturer **JRi**  
Open Length **309**  
Closed Length **259.4**  
Permitted Freedoms:

- **Spherical bearings may be replaced**

mm  
mm

Max  
Min

Photo of Front Damper Unmounted



Dimensions of Front Damper

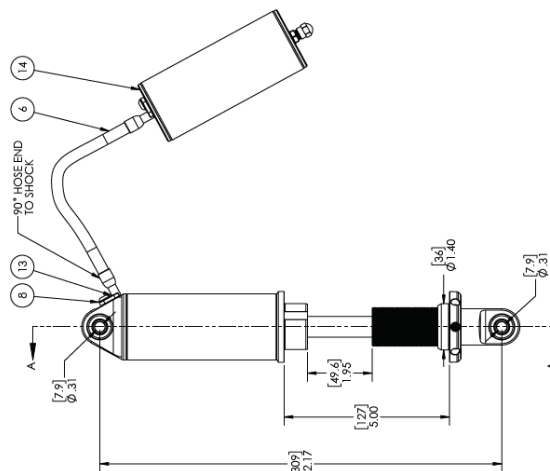



Photo of Front Damper Seal





## 5.9 FRONT SPRINGS (TYPE 1)

	Option 1	Option 2	Option 3
Type	<b>Coil</b>	<b>Coil</b>	<b>Coil</b>
Manufacturer	<b>King Springs</b>	<b>King Springs</b>	<b>King Springs</b>
Internal diameter	<b>36mm</b>	<b>36mm</b>	<b>36mm</b>
Free Length	<b>127mm</b>	<b>127mm</b>	<b>127mm</b>
Stiffness	<b>600lbs</b>	<b>700lbs</b>	<b>800lbs</b>
Photo			

## 5.10 FRONT BUMP RUBBER & PACKERS (TYPE 1)

Manufacturer	<b>Multimatic</b>		
Part Number	<b>P08 012 50</b>		
Dimensions	<b>OD: 32mm</b>	<b>ID: 16mm</b>	<b>H: 15mm</b>
Colour	<b>Blue</b>		
Quantity	<b>1</b>		

Photo of Front Bump Rubber Unmounted



Photo of Front Bump Rubber Hat Unmounted



Dimensions of Front Bump Rubber Hat

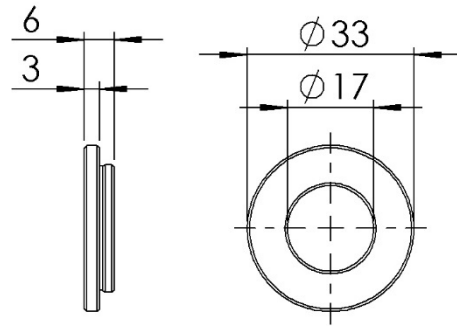
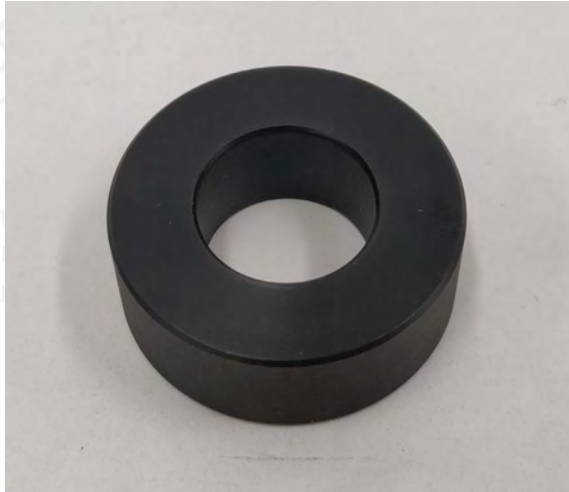

Photo of Front Solid Packer Unmounted



Dimensions of Front Solid Packer

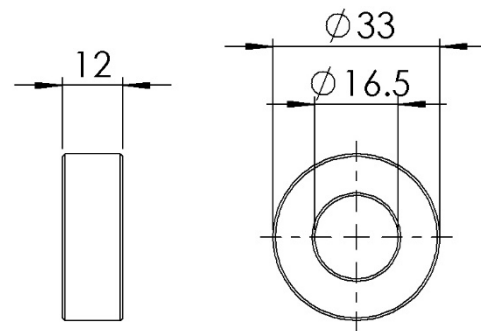
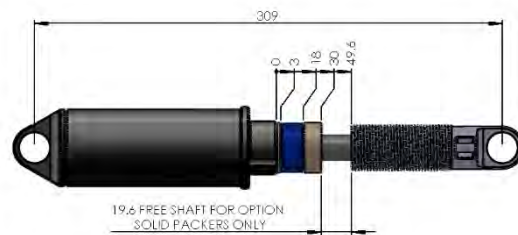

Photo of Complete Front Damper Bump Rubber and Packer Set



Dimensions of Complete Front Damper Bump Rubber and Packer Set





## 5.11 FRONT DAMPER PACKERS (OPTIONS) (TYPE 1)

Photo of Front Damper Removable Packer (5mm) Unmounted



Dimensions of Front Damper Removable Packer (5mm)

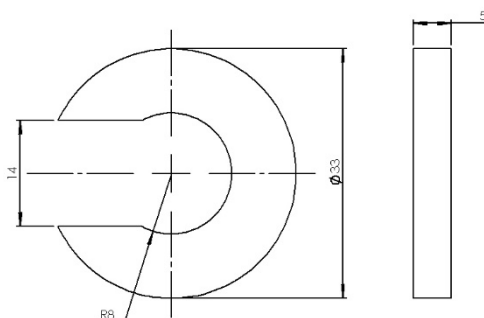

Photo of Front Damper Removable Packer (2mm) Unmounted



Dimensions of Front Damper Removable Packer (2mm)

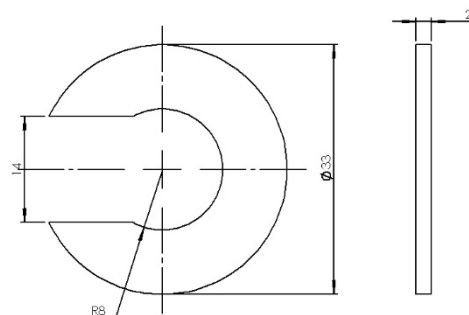
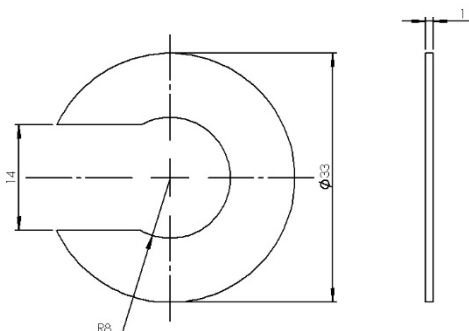

Photo of Front Damper Removable Packer (1mm) Unmounted



Dimensions of Front Damper Removable Packer (1mm)



## 5.12 FRONT ROCKER ASSEMBLY (TYPE 2)

Permitted Freedoms:

- **Bearings may be replaced**

Photo of Front Rocker Assembly Mounted



Photo of Front Rocker Unmounted



Dimensions of Front Rocker

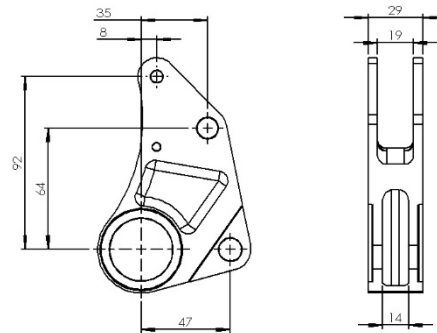

## 5.13 FRONT DAMPER CLEVIS (TYPE 1)

Photo of Front Damper Clevis Unmounted



Dimensions of Front Damper Clevis

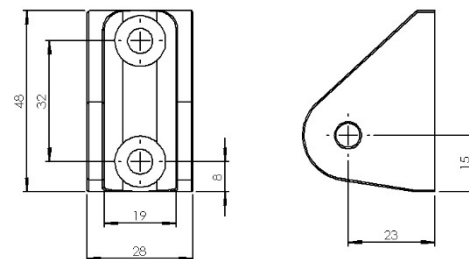



## 5.14 REAR SUSPENSION

Photo of RHS Rear Suspension Mounted



Photo of LHS Rear Suspension Mounted



## 5.15 REAR UPPER WISHBONE (TYPE 2)

Permitted Freedoms:

- Spherical bearings and rod ends may be replaced**

Photo of Rear Upper Wishbone Unmounted with Clevis



Dimensions of Rear Upper Wishbone

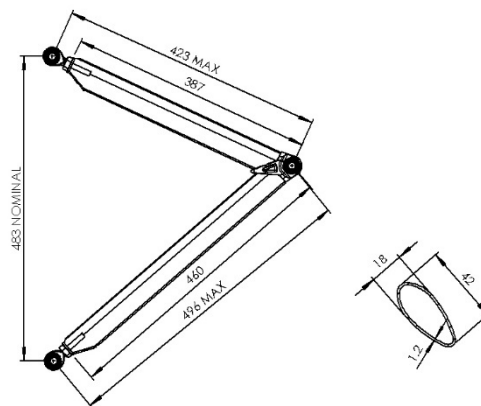

Photo of Rear Upper Wishbone Clevis (fore) Unmounted



Dimensions of Rear Upper Wishbone Clevis (fore)

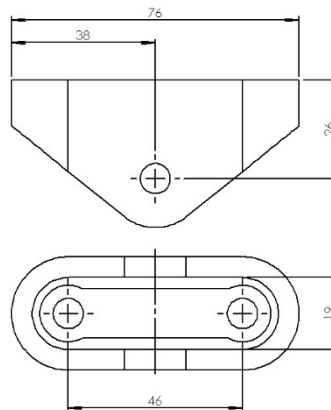
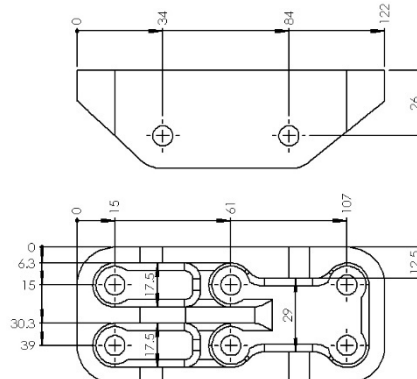

Photo of Rear Upper Wishbone Clevis (aft) Unmounted



Dimensions of Rear Upper Wishbone Clevis (aft)





## 5.16 REAR LOWER WISHBONE (TYPE 2)

Permitted Freedoms:

- **Spherical bearings and rod ends may be replaced**

Photo of Rear Lower Wishbone Unmounted with Clevis



Dimensions of Rear Lower Wishbone

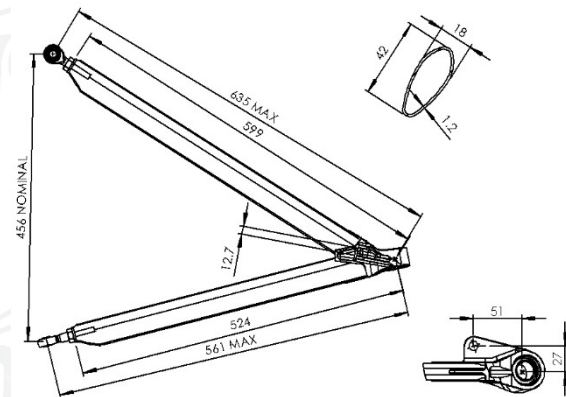

Photo of Rear Lower Wishbone Clevis (fore) Unmounted



Dimensions of Rear Lower Wishbone Clevis (fore)

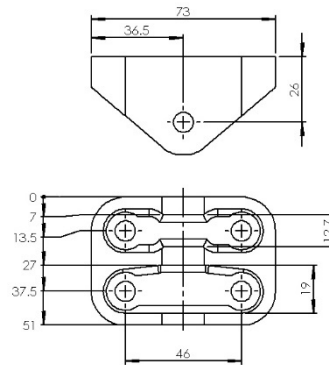
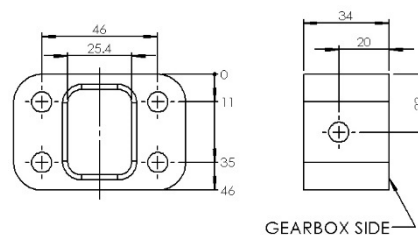

Photo of Rear Lower Wishbone Clevis (aft) Unmounted



Dimensions of Rear Lower Wishbone Clevis



## 5.17 REAR TOE LINK (TYPE 2)

Permitted Freedoms:

- **Spherical bearings and rod ends may be replaced**

Photo of Rear Toe Link Unmounted



Dimensions of Rear Toe Link

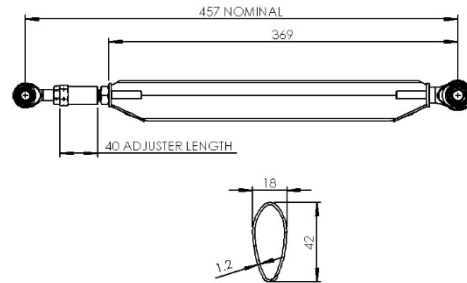

## 5.18 REAR PUSHROD (OPTION 1) (TYPE 2)

Permitted Freedoms:

- **Spherical bearings and rod ends may be replaced**

Photo of Rear Pushrod (Option 1) Unmounted



Dimensions of Rear Pushrod (Option 1)

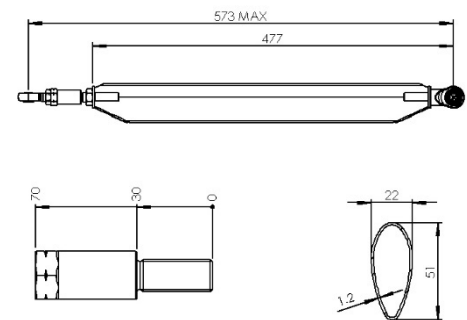



### 5.19 REAR PUSHROD (OPTION 2) (TYPE 2)

Permitted Freedoms:

- **Spherical bearings and rod ends may be replaced**

Photo of Rear Pushrod (Option 2) Unmounted



Dimensions of Rear Pushrod (Option 2)

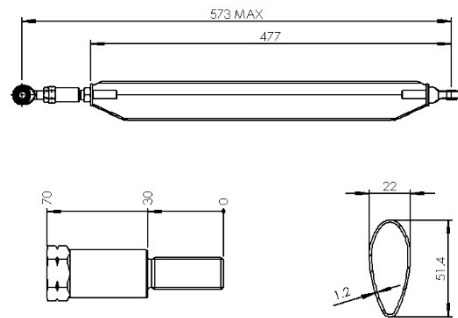

### 5.20 REAR PUSHROD (OPTION 3) (TYPE 2)

Permitted Freedoms:

- **Spherical bearings and rod ends may be replaced**

Photo of Rear Pushrod (Option 3) Unmounted



Dimensions of Rear Pushrod (Option 3)

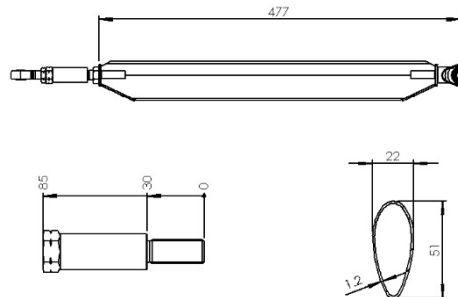

## 5.21 REAR PUSHROD (OPTION 4) (TYPE 2)

Permitted Freedoms:

- **Spherical bearings and rod ends may be replaced**

Photo of Rear Pushrod (Option 4) Unmounted



Dimensions of Rear Pushrod (Option 4)

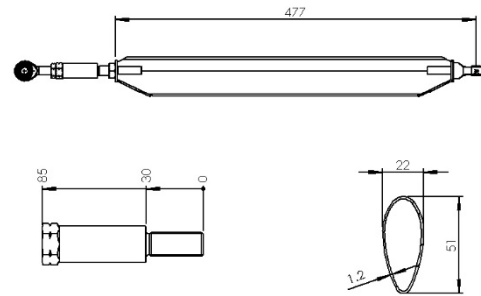

## 5.22 REAR ANTI ROLL BAR (TYPE 2)

Diameter **12** mm

Permitted Freedoms:

- **Bearings and rod ends may be replaced**
- **1 ARB link may be disconnected or removed**

Photo of Rear Anti Roll Bar Mounted



Photo of Rear Anti Roll Bar Unmounted



Dimensions of Rear Anti Roll Bar

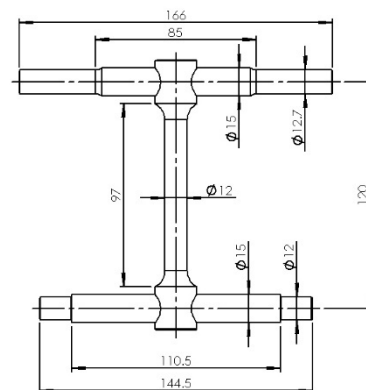



## 5.23 REAR DAMPER (TYPE 2)

Manufacturer **JRi**  
Open Length **309**  
Closed Length **259.4**  
Permitted Freedoms:

- **Spherical bearings may be replaced**

mm  
mm

Max  
Min

Photo of Rear Damper Unmounted



Dimensions of Rear Damper

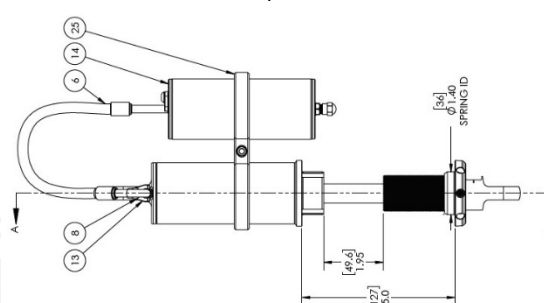

Photo of Rear Damper Seal



## 5.24 REAR SPRINGS (TYPE 1)

Type

Manufacturer

Internal diameter

Free Length

Stiffness

Photo

Option 1

Option 2

Option 3

Coil

Coil

Coil

King Springs

King Springs

King Springs

36mm

36mm

36mm

127mm

127mm

127mm

1000lbs

1100lbs

1200lbs



## 5.25 REAR BUMP RUBBER & PACKERS (TYPE 1)

Manufacturer

Multimatic

Part Number

P08 001 50

Dimensions

OD: 32mm

ID: 16mm

H: 15mm

Colour

Red

Quantity

2

Photo of Rear Damper Bump Rubber Unmounted





Photo of Rear Damper Bump Rubber Hat Unmounted



Dimensions of Rear Damper Bump Rubber Hat

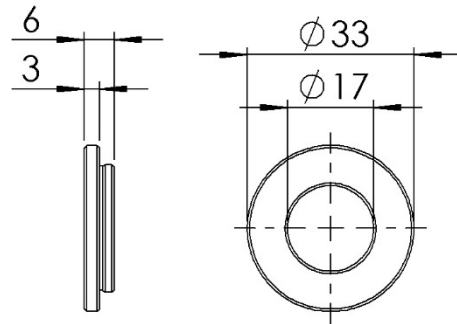

Photo of Rear Damper Solid Packer Unmounted



Dimensions of Rear Damper Solid Packer

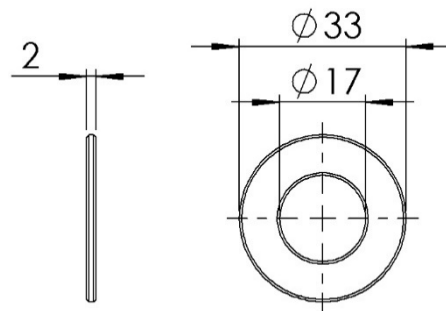
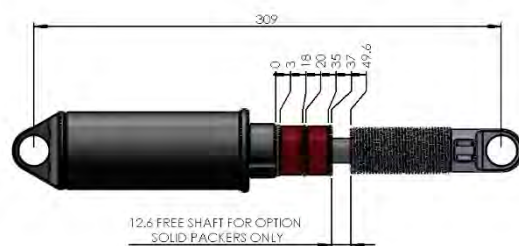

Photo of Complete Rear Damper Bump Rubber and Packer Set



Dimensions of Complete Rear Damper Bump Rubber and Packer Set



## 5.26 REAR DAMPER PACKERS (OPTIONS) (TYPE 1)

Photo of Rear Damper Removable Packer (5mm)  
Unmounted



Dimensions of Rear Damper Removable Packer  
(5mm)

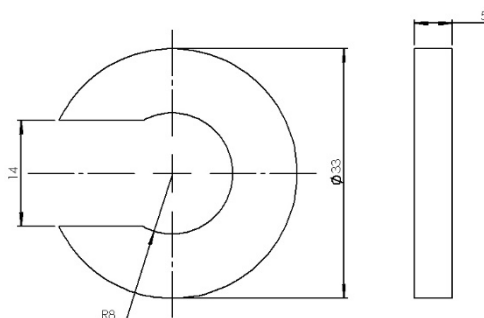

Photo of Rear Damper Removable Packer (2mm)  
Unmounted



Dimensions of Rear Damper Removable Packer  
(2mm)

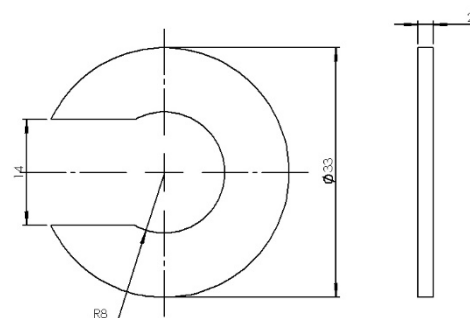
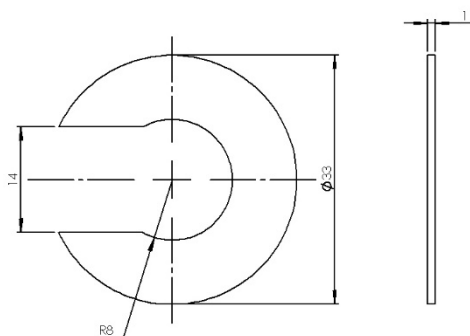

Photo of Rear Damper Removable Packer (1mm)  
Unmounted



Dimensions of Rear Damper Removable Packer  
(1mm)





## 5.27 REAR ROCKER ASSEMBLY (TYPE 2)

Permitted Freedoms:

- **Bearings may be replaced**

Photo of Rear Rocker Assembly Mounted



Photo of Rear Rocker Unmounted

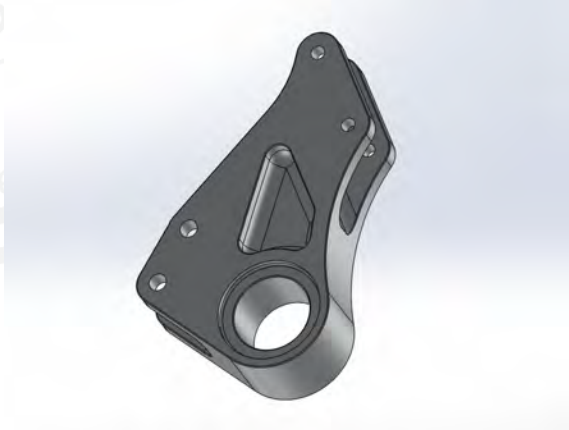

Dimensions of Rear Rocker

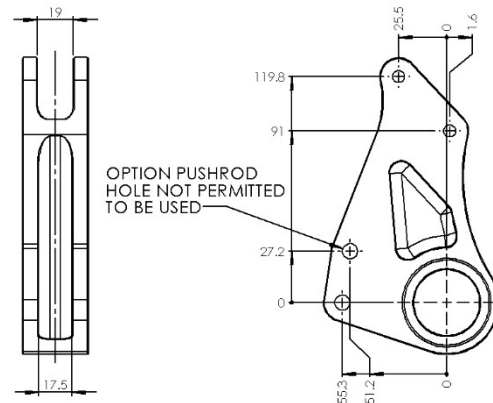

## 5.28 REAR DAMPER CLEVIS (TYPE 1)

Photo of Rear Damper Clevis Unmounted



Dimensions of Rear Damper Clevis

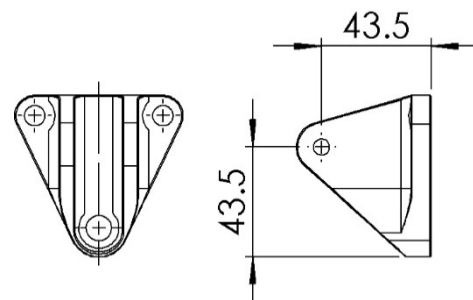

## 6 DRIVELINE

### 6.1 TRANSAXLE (TYPE 2)

Manufacturer **Holinger**  
 Part Number **MFT-S5000**  
 Transaxle Oil Type **Valvoline SynGear 75W140**  
 Dropgear Oil Type **Valvoline SynGear 75W140**  
 Transaxle ID Number **MMYY-XXX** 'XXX' Sequential number  
 Permitted Freedoms:

- **Oil may be replaced**

Photo of Transaxle Unmounted



Photo of Transaxle Unmounted

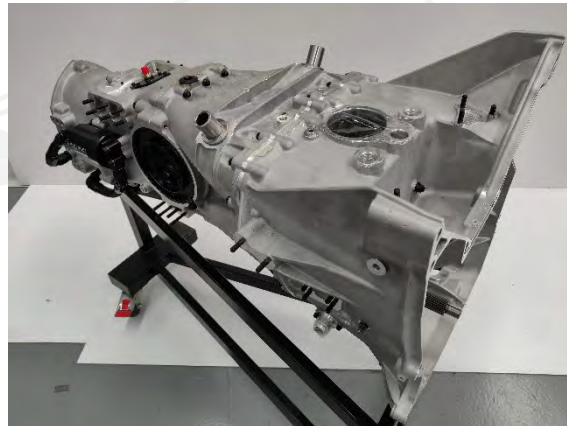

Photo of Transaxle Unmounted



Photo of Transaxle Unmounted

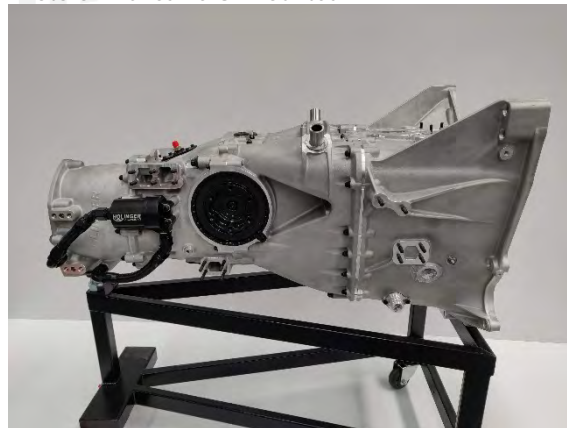

Photo of Transaxle Unmounted



Photo of Transaxle Unmounted





Photo of Transaxle Seal Location 1

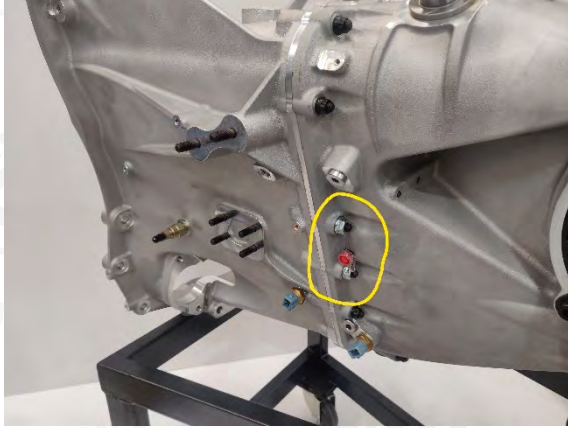

Photo of Transaxle Seal Location 2

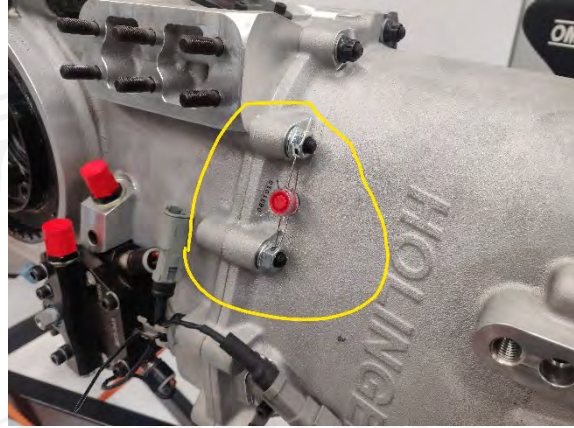

Photo of Transaxle ID Number Location



Photo of Differential Seal LHS



Photo of Differential Seal RHS



## 6.2 TRANSAXLE COOLER (TYPE 1)

Photo of Transaxle Cooler Mounted



## 6.3 CLUTCH (TYPE 2)

Manufacturer **Tilton**  
Part Number **6553HSG-S**  
Permitted Freedoms:

- **Shims may be added to account for wear**

Photo of Clutch Unmounted



Photo of Clutch Unmounted





#### 6.4 CLUTCH SLAVE CYLINDER (TYPE 2)

Manufacturer

**Holinger**

Part Number

**ACR-003-18-38**

Permitted Freedoms:

- **May be serviced within manufacturers tolerance**

Photo of Clutch Slave Cylinder Mounted



#### 6.5 SPINDLE (TYPE 1)

Photo of Spindle Unmounted



Dimensions of Spindle

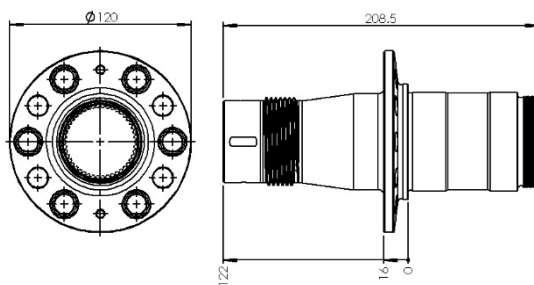

## 6.6 WHEEL BEARING (TYPE 1)

Part Number **32913**

# of Rollers **36**

Photo of Wheel Bearing Unmounted



## 6.7 UPRIGHT BEARING SEAL (TYPE 1)

Manufacturer **SKF**

Part Number **29850**

Photo of Upright Bearing Seal Unmounted





## 6.8 DRIVESHAFT (TYPE 2)

Manufacturer **GKN**  
Part Number **290-MSP01-143**  
Permitted Freedoms:

- **CV's may be serviced**

Photo of Driveshaft Unmounted



Dimensions of Driveshaft

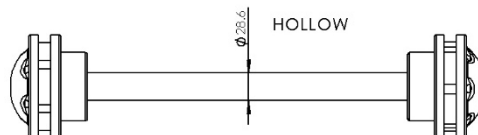

## 6.9 DRIVESHAFT (OPTION) (TYPE 2)

Manufacturer **Holinger**  
Part Number **TBA**  
Permitted Freedoms:

- **CV's may be serviced**

Photo of Driveshaft Unmounted



Dimensions of Driveshaft

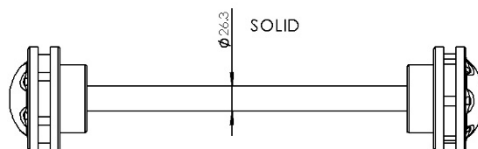

## 6.10 DRIVE FLANGE (TYPE 1)

Photo of Drive Flange Unmounted



Photo of Drive Flange Unmounted





## 6.11 WHEEL NUT (TYPE 2)

Permitted Freedoms:

- **Damaged threads may be repaired**

Photo of Wheel Nut Unmounted



Photo of Wheel Nut Unmounted



## 6.12 SHIFT PADDLES (TYPE 1)

Manufacturer

**Holinger**

Part Number

**220-HE0004999005A**

Photo of RHS Shift Paddle Mounted



Photo of LHS Shift Paddle Mounted



### 6.13 AIR COMPRESSOR (TYPE 2)

Manufacturer **VIAIR**

Part Number **27520**

Permitted Freedoms:

- **Air filter may be serviced/replaced**

Photo of Air Compressor Mounted

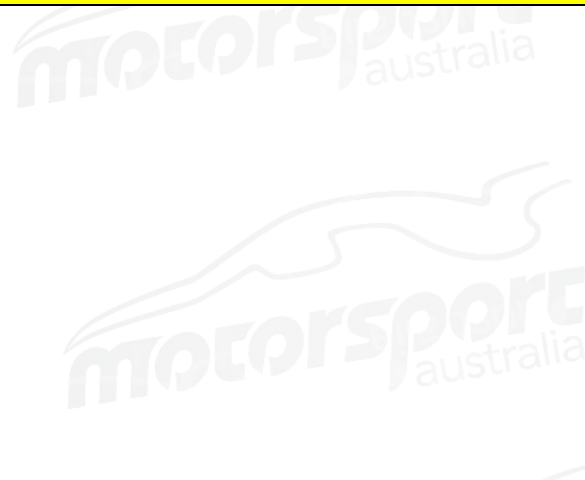

Photo of Air Compressor Unmounted



### 6.14 AIR TANK (TYPE 1)

Photo of Air Tank Mounted





## 6.15 ACTUATOR (TYPE 2)

Manufacturer **Holinger**

Permitted Freedoms:

- **May be serviced from the direction of Holinger**

Photo of Actuator Mounted



## 7 BRAKES AND PEDAL BOX

### 7.1 BRAKE CALIPER RHS (TYPE 2)

Manufacturer **AP Racing**  
 Part Number **CP9440-2S4L**  
 Position **FR, RR**  
 Piston Diameters **36, 41.3** mm  
 Permitted Freedoms:
 

- **Seals may be replaced**

Photo of RHS Brake Caliper Unmounted



Photo of RHS Brake Caliper Unmounted



### 7.2 BRAKE CALIPER LHS (TYPE 2)

Manufacturer **AP Racing**  
 Part Number **CP9440-3S4L**  
 Position **FL, RL**  
 Piston Diameters **36, 41.3** mm  
 Permitted Freedoms:
 

- **Seals may be replaced**

Photo of LHS Brake Caliper Unmounted



Photo of LHS Brake Caliper Unmounted





### 7.3 BRAKE PAD (TYPE 2)

Manufacturer **PFC**  
Type **PFC11**  
Permitted Freedoms:

- **May be supplied through GRM or Competition Friction**

Photo of Brake Pad Unmounted



Photo of Brake Pad Unmounted



### 7.4 BRAKE DISC RHS (TYPE 2)

Manufacturer **AP Racing**  
Part Number **CP3580-2572 G4**  
Position **FR, RR**  
Diameter **304** mm  
New Thickness **27.94** mm **±0.08** mm  
Minimum Thickness **25-2 26.5** mm  
Permitted Freedoms:

- **May be supplied through GRM or Competition Friction**

Photo of RHS Brake Disc Unmounted



Photo of RHS Brake Disc Unmounted



## 7.5 BRAKE DISC LHS (TYPE 2)

Manufacturer	AP Racing		
Part Number	CP3580-2573 G4		
Position	FL, RL		
Diameter	304	mm	
New Thickness	27.94	mm	±0.08 mm
Minimum Thickness	25.2 26.5	mm	
Permitted Freedoms:			

- May be supplied through GRM or Competition Friction

Photo of LHS Brake Disc Unmounted



Photo of LHS Brake Disc Unmounted



## 7.6 BRAKE DUCT FRONT (TYPE 1)

Photo of Front Brake Duct Unmounted



Photo of Front Brake Duct Mounted





## 7.7 BRAKE DUCT REAR (TYPE 1)

Photo of Rear Brake Duct Unmounted



Photo of Rear Brake Duct Mounted



## 7.8 BRAKE MASTER CYLINDER (FRONT) (TYPE 2)

Manufacturer **Tilton**  
Part Number **76-812**  
Position **Front Brake**  
Piston Size **20.6** mm  
Permitted Freedoms:

- **Seals may be replaced**

Photo of Front Brake Master Cylinder Unmounted



## 7.9 BRAKE MASTER CYLINDER (REAR) (TYPE 2)

Manufacturer **Tilton**  
 Part Number **76-875**  
 Position **Rear Brake**  
 Piston Size **22.2** mm  
 Permitted Freedoms:

- **Seals may be replaced**

Photo of Rear Brake Master Cylinder Unmounted



## 7.10 CLUTCH MASTER CYLINDER (TYPE 2)

Manufacturer **Tilton**  
 Part Number **76-750**  
 Position **Clutch**  
 Piston Size **19.05** mm  
 Permitted Freedoms:

- **Seals may be replaced**

Photo of Clutch Master Cylinder Unmounted





## 7.11 PEDAL BOX (TYPE 2)

Manufacturer

**Tilton**

Part Numbers

**72-603 w/ 72-792 & 72-250 &  
GRM-AI0535-00**

Permitted Freedoms:

- **Bearings may be replaced**
- **Grip tape may be applied to the pedal pad faces**

Photo of Pedal Box Assembly Unmounted

\*Fittings may differ from photos



Photo of Pedal Box Assembly Unmounted



Photo of Pedal Box Assembly Unmounted



Photo of Pedal Box Assembly Unmounted



Photo of Pedal Box Assembly Unmounted



Photo of Balance Bar Assembly Unmounted



Photo of Balance Bar Washers Installed



### 7.12 FLUID RESERVOIR (TYPE 3)

Manufacturer **Tilton**  
Part Number **72-577**

Photo of Fluid Reservoir Mounted

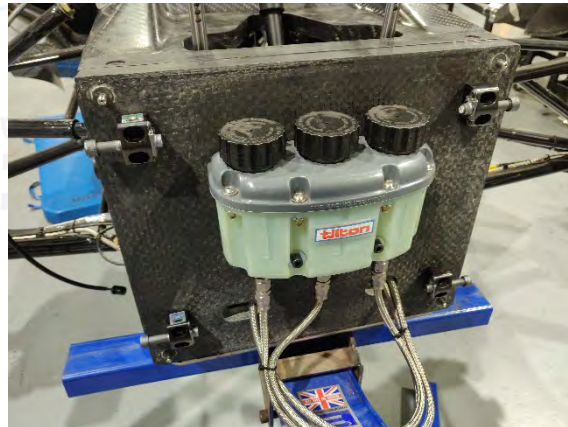



## 8 STEERING

### 8.1 STEERING RACK (TYPE 1)

Ratio **36.8**

mm/Turn

Lock to Lock **548**

deg

Photo of Steering Rack Mounted



Dimensions of Steering Rack

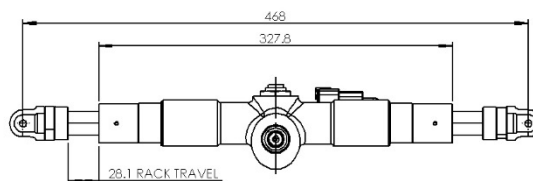

Photo of Steering Rack Unmounted



Photo of Steering Rack Unmounted



Photo of Steering Rack Clevis Mounted



## 8.2 STEERING COLUMN (TYPE 2)

Permitted Freedoms:

- **Bearings may be replaced**

Photo of Steering Column Uni Joint and Mounting



Photo of Steering Column Assembly Unmounted



## 8.3 STEERING ARM (TYPE 2)

Permitted Freedoms:

- **Spherical bearings and rod ends may be replaced**

Photo of Steering Arm Unmounted



Dimensions of Steering Arm

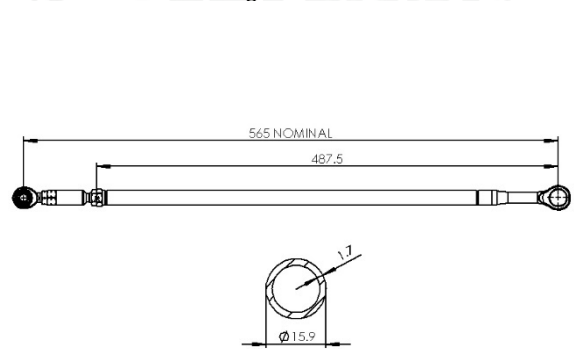

## 8.4 STEERING WHEEL (TYPE 1)

Photo of Steering Wheel Unmounted



Photo of Steering Wheel Unmounted





## 8.5 STEERING WHEEL (OPTION) (TYPE 2)

Permitted Freedoms:

- **Up to 4x 5mm spacers can be used**

Photo of Steering Wheel (Option) Unmounted



## 9 WHEELS

### 9.1 FRONT WHEEL (TYPE 2)

Manufacturer **Max Wheels**  
Part Number **GRM-AP0203**  
Dimensions **15"x10"**  
Offset **0**

Permitted Freedoms:

- **May be straightened to repair damage**
- **May be supplied through GRM or Max Wheels**
- **Outer surface (as shown below) can be painted**

Photo of Front Wheel Unmounted



Photo of Front Wheel Unmounted



Photo of Front Wheel Unmounted



Allowable painted surface

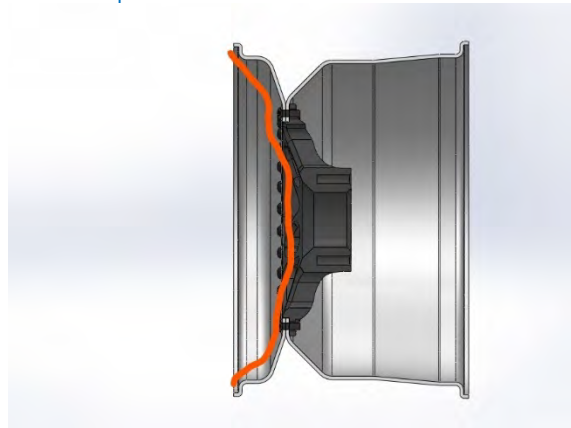



## 9.2 REAR WHEEL (TYPE 2)

Manufacturer **Max Wheels**  
Part Number **GRM-AP0204**  
Dimensions **15"x15"**  
Offset **-63.6mm**

Permitted Freedoms:

- **May be straightened to repair damage**
- **May be supplied through GRM or Max Wheels**
- **Outer surface (as shown below) can be painted**

Photo of Rear Wheel Unmounted



Photo of Rear Wheel Unmounted



Photo of Rear Wheel Unmounted



Allowable painted surface

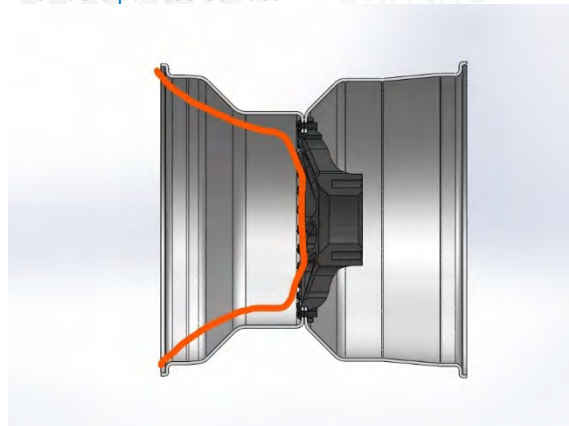

## 10 ELECTRICAL SYSTEM

### 10.1 MAIN CHASSIS LOOM (TYPE 1)

Part Number **GRM-AT0465**

Photo of Main Chassis Loom Unmounted



Schematic (refer to manufacturer documentation)

### 10.2 FRONT CHASSIS LOOM (TYPE 1)

Part Number **GRM-AT0504**

Photo of Front Chassis Loom Unmounted



Schematic (refer to manufacturer documentation)

### 10.3 ENGINE LOOM (TYPE 1)

Part Number **GRM-AT0466**

Photo of Engine Loom Unmounted

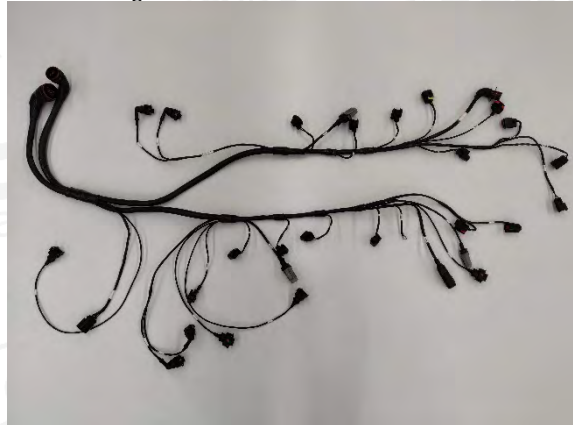

Schematic (refer to manufacturer documentation)



#### 10.4 TRANSMISSION LOOM (TYPE 1)

Part Number **GRM-AT0467**

Photo of Transmission Loom Unmounted



Schematic (refer to manufacturer documentation)

#### 10.5 BATTERY CABLES (TYPE 1)

Part Number **GRM-AT0505**

Photo of Battery Cables Unmounted



Schematic (refer to manufacturer documentation)

#### 10.6 ELECTRONIC HARDWARE (TYPE 1)







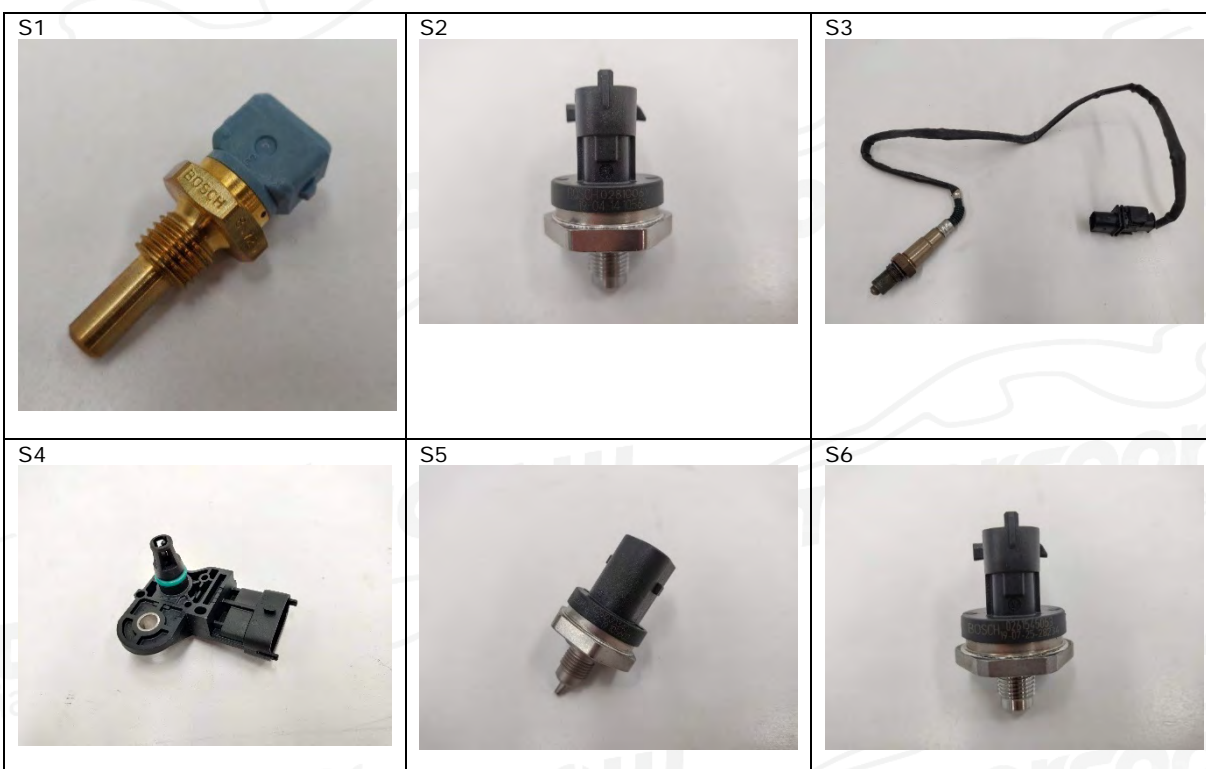



	Model	Part Number	Manufacturer
ECU	<b>M150 w/ GPRP, Level 2 Logging Level 3 Logging</b>	<b>13150 w/ 23068, <del>23011</del> 23012</b>	<b>MoTeC</b>
PDM	<b>PDM15</b>	<b>14104</b>	<b>MoTeC</b>
Data Logger	<b>L120 w/ 120MB Logging, I/O, Pro Analysis</b>	<b>18045 w/ 29619, 29601, 29621</b>	<b>MoTeC</b>
Display	<b>D153</b>	<b>18027v</b>	<b>MoTeC</b>
Video Camera	<b>v2 Video Kit</b>	<b>18210</b>	<b>MoTeC</b>
Shift Light	<b>SLM</b>	<b>18120v</b>	<b>MoTeC</b>
Keypad	<b>8 Button Keypad</b>	<b>41401</b>	<b>MoTeC</b>
Lambda to CAN	<b>LTCD</b>	<b>61301S</b>	<b>MoTeC</b>
Ignition Module		<b>0 227 100 211</b>	<b>Bosch</b>

## 10.7 SENSORS & ACTUATORS (TYPE 1)

Ref	Location	Part Number	Manufacturer	
<b>S1</b>	Engine Oil	<b>0 280 130 026</b>	<b>Bosch</b>	Temperature
	Engine Coolant			
	Trans – Drop Gear			
	Trans – Gearbox			
	Trans – Engine Oil (NC)			
<b>S2</b>	Engine Oil	<b>0 281 006 119</b>	<b>Bosch</b>	Pressure
	Engine Coolant			
	Shift Accumulator			
<b>S3</b>	Lambda	<b>0 258 988 001</b>	<b>Bosch</b>	Lambda
<b>S4</b>	Airbox	<b>0 261 230 217</b>	<b>Bosch</b>	Temperature & Pressure
<b>S5</b>	Fuel	<b>0 261 230 340</b>	<b>Bosch</b>	Temperature & Pressure
<b>S6</b>	Front Brake	<b>0 261 545 053</b>	<b>Bosch</b>	Pressure
	Rear Brake			
	Clutch			
<b>S7</b>	Throttle Pedal	<b>Euro XPD 2832-812-214-911-00-TUS</b>	<b>Variohm</b>	Rotary Position
<b>S8</b>	Steering	<b>RSM-2841-003-211-202</b>	<b>Novotechnik</b>	Rotary Position
<b>S9</b>	Wheel Speed	<b>1GT101DC</b>	<b>Honeywell</b>	Hall Effect
<b>S10</b>	Gear	<b>NRH280DP/360/360/A4/3/M/P5/R</b>	<b>P&amp;G</b>	Rotary Position
<b>S11</b>	GPS	<b>41304V (GPS-L10)</b>	<b>MoTeC</b>	
<b>S12</b>	Crank sensor	<b>BR3E-6C315-AC</b>	<b>Ford</b>	
<b>S13</b>	Cam sensor (Inlet)	<b>9L8E-12K073-AD</b>	<b>Ford</b>	
<b>S14</b>	Cam sensor (Exhaust)	<b>BR3E-6B288-AA</b>	<b>Ford</b>	
<b>S15</b>	Throttle body	<b>FR3E-9F991-AA</b>	<b>Ford</b>	
<b>S16</b>	Knock	<b>AL3Z-12A699-BA</b>	<b>Ford</b>	
<b>S17</b>	Injector	<b>0 280 158 279</b>	<b>Bosch</b>	
<b>S18</b>	Coil	<b>FR3E-12A375-AA</b>	<b>Ford</b>	
<b>S19</b>	Spark Plug	<b>CYFS-092-YPT3</b>	<b>Ford</b>	



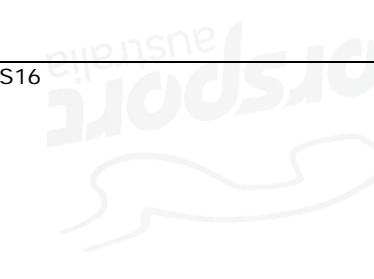
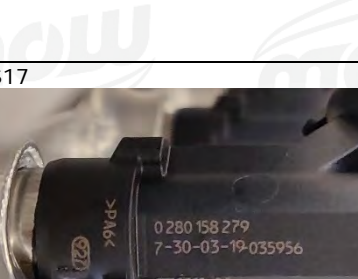

<p>S7</p> 	<p>S8</p> 	<p>S9</p> 
<p>S10</p> 	<p>S11</p> 	<p>S12</p> 
<p>S13</p> 	<p>S14</p> 	<p>S15</p> 
<p>S16</p> 	<p>S17</p> 	<p>S18</p> 
<p>S19</p> 		

## 10.8 CAMERA HOUSING (TYPE 1)

Photo of Camera Housing Mounted





## 11 ENGINE

### 11.1 ENGINE (TYPE 1)

Manufacturer **InnoV8**

Engine ID Number **XXX**

**"XXX" Sequential Number**

Photo of Engine Unmounted



Photo of Engine Unmounted



Photo of Engine Seal Location 1 (RH Rocker Cover)



Photo of Engine Seal Location 2 (LH Rocker Cover)



Photo of Engine ID Number Location





## 11.2 FLYWHEEL (TYPE 1)

Photo of Flywheel Mounted

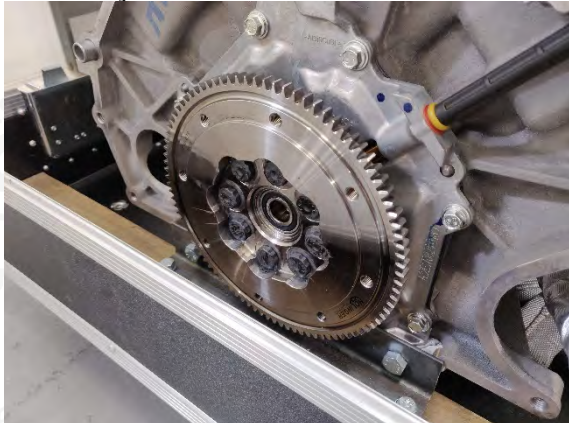

## 11.3 INTAKE SYSTEM (TYPE 1)

Air Filter Manufacturer

**K&N**

Air Filter Part #

**33-2116**

**QTYx2**

Photo of Intake System Mounted



Photo of Intake System Mounted



Photo of Throttle Body Mounted

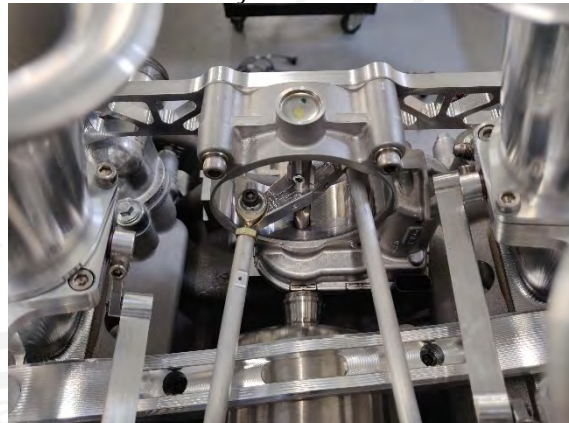

Photo of Throttle Linkage Mounted





#### 11.4 WATER COOLING SYSTEM (TYPE 2)

Permitted Freedoms:

- **Coolant may be replaced**
- **Blanking may be placed on the mesh inside the duct in front of the radiator**

Photo of RH Radiator Mounted

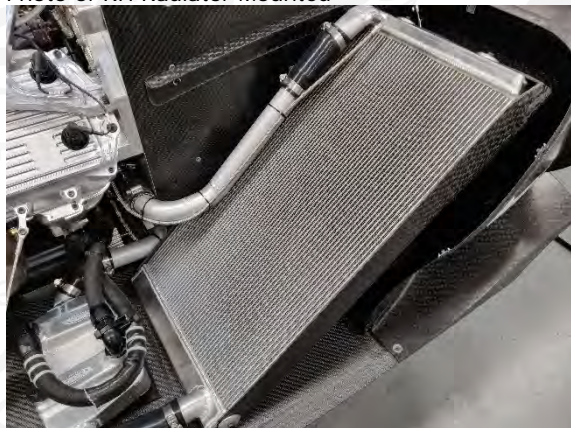

Photo of LH Radiator Mounted



Photo of Water Header Tank Mounted





### 11.5 OIL SYSTEM (TYPE 2)

Oil Filter Manufacturer **K&N**  
Oil Filter Part # **HP-2010**  
Engine Oil Type **Valvoline PRO-V Racing 20W-50**  
Permitted Freedoms:  
• **Oil may be replaced**

Photo of Oil Cooler Mounted



Photo of Oil Filter Mounted



Photo of Oil Return Filter and Tank Mounted



### 11.6 EXHAUST PRIMARIES (TYPE 1)

Photo of RH Exhaust Primaries Mounted



Photo of LH Exhaust Primaries Mounted





### 11.7 EXHAUST SECONDARIES (TYPE 1)

Photo of RH Exhaust Secondaries mounted



Photo of RH Exhaust Secondaries Unmounted



Photo of LH Exhaust Secondaries Mounted



Photo of LH Exhaust Secondaries Unmounted



### 11.8 EXHAUST MUFFLER AND TIP (TYPE 1)

Photo of Exhaust Muffler and Tip Mounted



Dimensions of Muffler

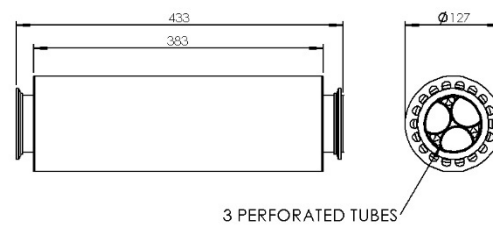

### 11.9 EXHAUST MUFFLER AND TIP (OPTION) (TYPE 1)

Photo of Muffler Delete Tip (Option)





## 12 FUEL SYSTEM

### 12.1 FUEL TANK (TYPE 1)

Manufacturer **ATL**

Photo of Fuel Tank Bladder Unmounted



Photo of Fuel Tank Bladder Unmounted



### 12.2 FUEL PUMP (TYPE 3)

Manufacturer **Walbro**

Part Number **GSS340**

Photo of Fuel Pump Mounted



Photo of Fuel System Unmounted

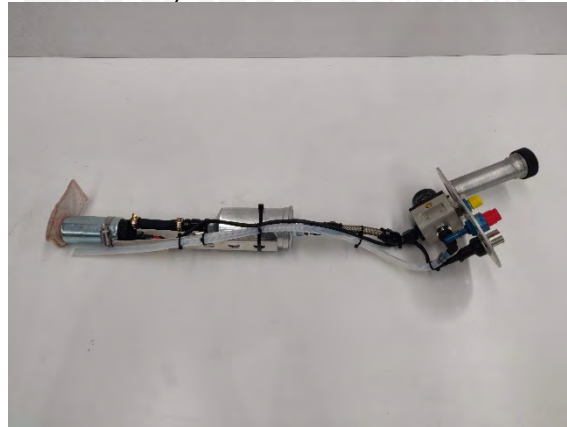

### 12.3 FUEL FILTER (TYPE 3)

Manufacturer **Bosch**  
Part Number **0 450 905 021**

Photo of Fuel Filter Mounted



### 12.4 FUEL REGULATOR (TYPE 1)

Manufacturer **Edelbrock**  
Part Number **1729**  
Fuel Pressure **56** psi Max

Photo of Fuel Regulator Mounted





## 12.5 DOCUMENT REVISION NOTES

Document #	Date	Notes
1-20-004	10/3/2020	Initial Release
1-20-004 Version 2	16/11/2021	<ol style="list-style-type: none"> <li>Updated skid block drawing and photo to reflect spark block addition (Tech Bulletin #13)</li> <li>Added spark block photo and drawing (Tech Bulletin #13)</li> <li>Updated and added front and rear upright photos to show aluminium tape over speed sensor web (Tech Bulletin #10)</li> <li>Added wording to allow for front and rear ARB link disconnection (2021 Symmons Plains Technical Report)</li> <li>Added 5mm removable damper packer front and rear photo and drawing</li> <li>Added all options for rear pushrod (top &amp; bottom adjuster, original and long adjuster) (Tech Bulletin #8)</li> <li>Added driveshaft option</li> <li>Updated minimum thickness on brake rotors and added AP Racing's thickness tolerance to a new rotor</li> <li>Added photos of pedal box with brake balance bar washers installed (Tech Bulletin #7)</li> <li>Added option short steering wheel housing (Tech Bulletin #9)</li> <li>Added wording and drawings for allowable painted surface of wheels (2021 S5000 Tasman Series Technical Regulations T17.1)</li> <li>Updated ECU options to include level 3 logging</li> <li>Updated photo of intake system to include airbox duct (Tech Bulletin #14)</li> </ol>